



530 Series

Low Backline Pressure Modular Belt Solutions

Movex®

www.movexii.com

530

Low Backline Pressure Modular Belt Solutions



Accumulation

Ideal for accumulation applications with small and light goods.



Optimized transfer

530 Low Backline Pressure minimizes transfer area's and can avoid the use of dead plates



Energy saving

Minimized power consumption thanks to reduced friction and low belt weight.



PFX rollers

Lowest coefficient of friction guaranteed thanks to PFX rollers (530 PRO LBP).



Driven possibility

The belt can also be installed with rollers driven by guides (double speed).



User-friendliness

Easy installation and interchangeability.

The best choice for the optimization of the production flow

Movex® 530 Low Backline Pressure Modular Belt Series is the ideal choice for **accumulation applications** and to minimize the transfer areas.

Available in two different versions, the 530 LBP (3 rows of rollers) has a density of 700 rollers per square meter and the 530 PRO LBP (4 rows of rollers) has a density of 3.400 rollers per square meter, offering a more homogeneous product support.

Moreover, the 530 PRO LBP is assembled with Patented Pin Sphere ® system and is suitable for Movex Transfer plates with rollers.

Both 530 LBP and 530 PRO LBP guarantee a **double possibility** of using:

- for **accumulation system**
- driven rollers, **to double the product speed**

The two different configurations allow a great versatility with the same product.





Characteristics Comparison

530 LBP

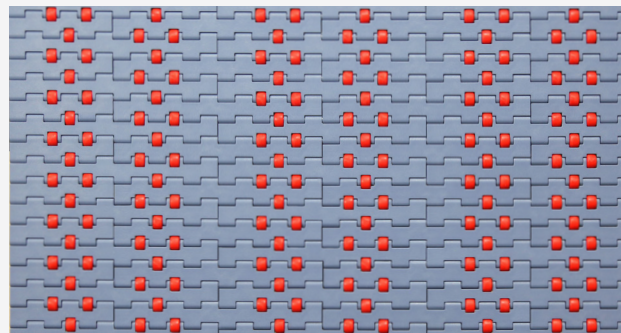

530 PRO LBP

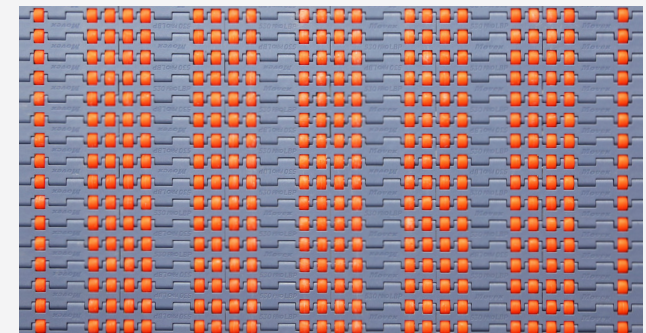

General products features



Belt pitch	15 mm
Max Load	24.000N/m
Roller Density	700 rollers/m2
Rollers material	POM red
Suitable for Patented Movex transfer plate with bearings	
Assembled with pins and clips	

Belt pitch	15 mm
Max Load	21.000N/m
Roller Density	3.400 rollers/m2
Rollers material	PFX
Suitable for Patented Movex transfer plate with bearings	
Assembled with Patented Movex Pin Sphere®	

530 LBP

Technical specifications

Technical features

Material			
LFA - Code 01 Low friction Acetal			
Pitch:	15 mm	Max w. load:	24000 N/m
Thickness:	8,7 mm	Weight:	9,0 kg/m ²
Width Increments	152.4 mm	Temp. range dry:	-40÷80 °C
Backflex radius min.	25 mm	Temp. range dry:	-40÷65 °C

Roller	
Material:	POM Red
Density:	700 rollers/m ²
Pin	
Pin Material:	PBT White
Drive method (recommended)	
Center/Hinge-Driven	

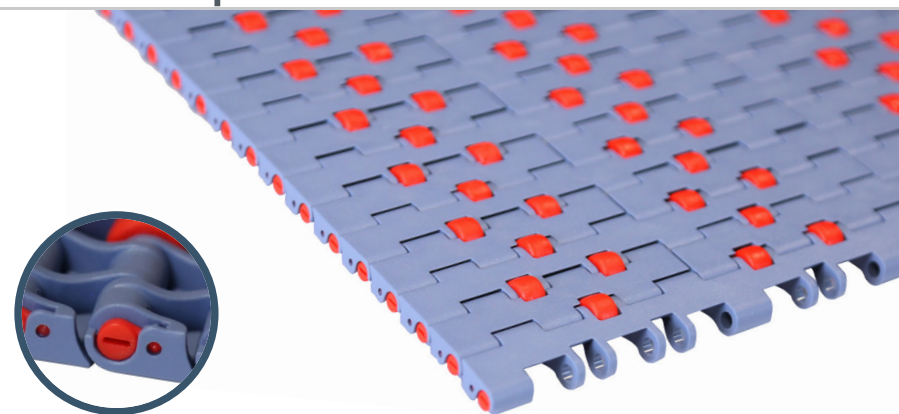

Product order code

Belt Width	Article Nr.
0006	5324010006A
0012	5324010012A
0018	5324010018A
0024	5324010024A
0030	5324010030A
0036	5324010036A
0042	5324010042A
0048	5324010048A
0054	5324010054A

* Belts wider than 54 inch are available with 6 inch increments.

Version A - Standard

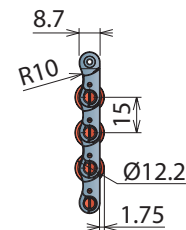
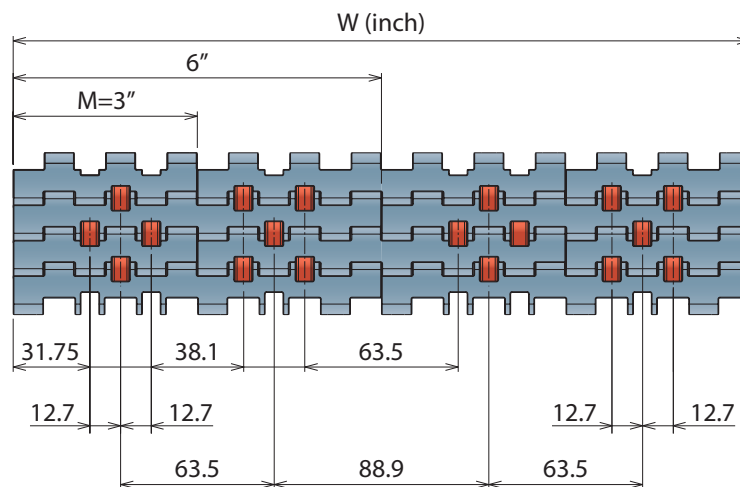

Advantages:

- Less Noise
- Less energy consumption
- Head Drive
- Center Drive
- Short Transfer



Supplied coil length: Width ≤ 12 in: 3 meter (200 pitches) | Width > 12 in: 1,5 meter (100 pitches)

Technical features

Belt Material			
LFA - Code 01 Low friction Acetal			
Pitch:	15 mm	Max w. load:	21000 N/m
Thickness:	8,7 mm	Weight:	10,0 kg/m ²
Width Increments	76.2 mm	Temp. range dry:	-40÷80 °C
Backflex radius min.	25 mm	Temp. range dry:	-40÷65 °C

PFX Roller	
Density:	3.400 rollers/m ²
THE BEST CHOICE TO REACH THE LOWEST FRICTION	
Pin	
Pin Material:	PBT White
Drive method (recommended)	
Center/Hinge-Driven	



Pin Sphere®
AUTOLOCK

Product order code

Width	Article Nr.
0006	5237010006A
0009	5237010009A
0012	5237010012A
0015	5237010015A
0018	5237010018A
0021	5237010021A
0024	5237010024A
0027	5237010027A
0030	5237010030A
0033	5237010033A
0036	5237010036A
0039	5237010039A
0042	5237010042A
0045	5237010045A
0048	5237010048A
0051	5237010051A
0054	5237010054A

Version A - Standard

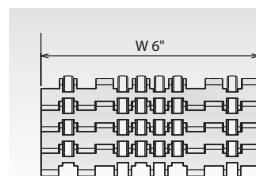
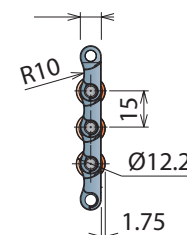
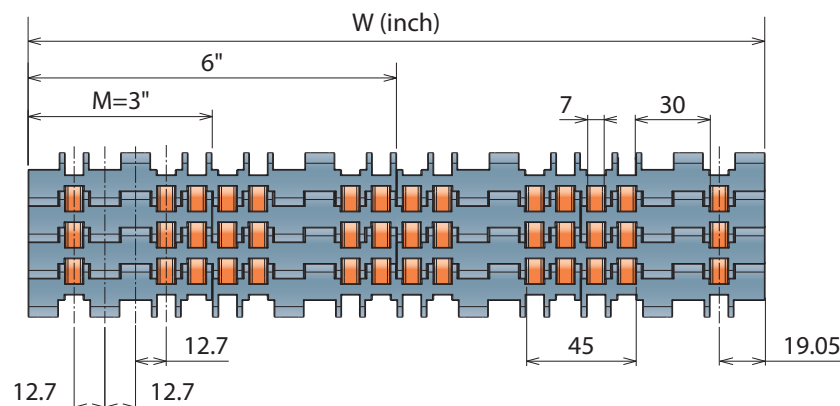

Rollers configuration for 530 PRO LBP, 6 inch wide belt.

Advantages:

- ▶ Less Noise
- ▶ Less energy consumption
- ▶ High Density
- ▶ Head Drive
- ▶ Center Drive
- ▶ Pin Sphere
- ▶ Short Transfer
- ▶ PFX Rollers

* Belts wider than 54 inch are available with 3 inch increments.



Supplied coil length: Width ≤ 12 in: 3 meter (200 pitches) | Width > 12 in: 1,5 meter (100 pitches)

530 LBP

Guides

Guide position for accumulation system - Example

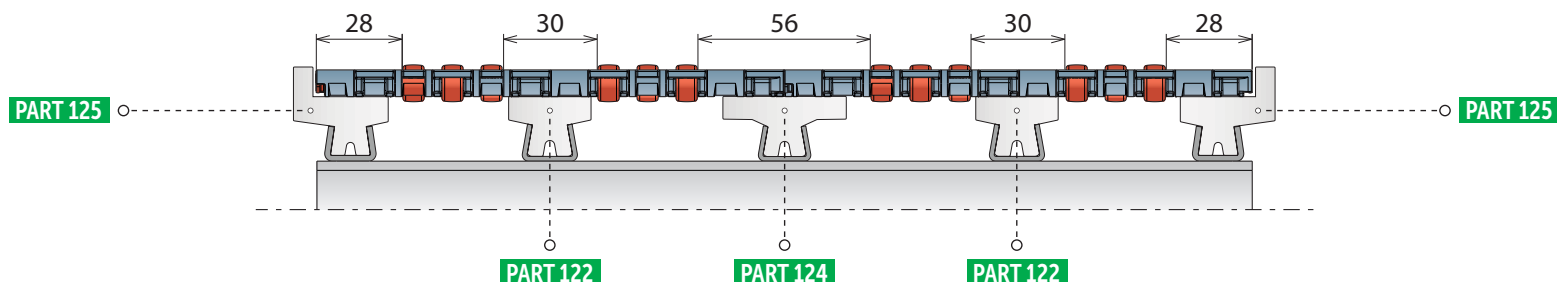

Guide position for driven rollers, for alignment/distribution system - Example

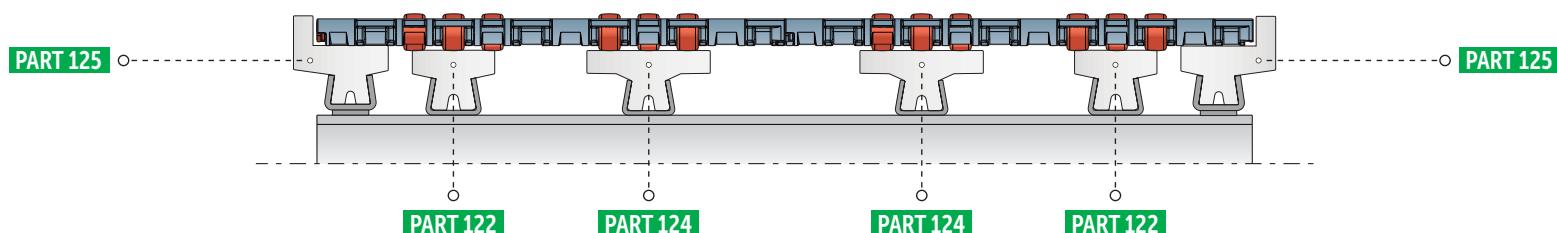

Part	Article-Nr.	Thickness	Metal profile	Colour	Type
122	12263	1.9	AISI 304	white	
122	12201C	1.5	AISI 304	white	

Part	Article-Nr.	Thickness	Metal profile	Colour	Type
124	12463	1.9	AISI 304	white	
124	12401C	1.5	AISI 304	white	

Part	Article-Nr.	Thickness	Metal profile	Colour	Type
125	12563	1.9	AISI 304	white	
125	12501C	1.5	AISI 304	white	



GENERAL RULES

For accumulation system, please place the wear strips between the rollers (max 50 mm).
For driven rollers, please place the wear strips directly in contact under the rollers.
530 LBP can also be used with standard profiles: consult our general catalog for more details.

Guide position for accumulation system - Example

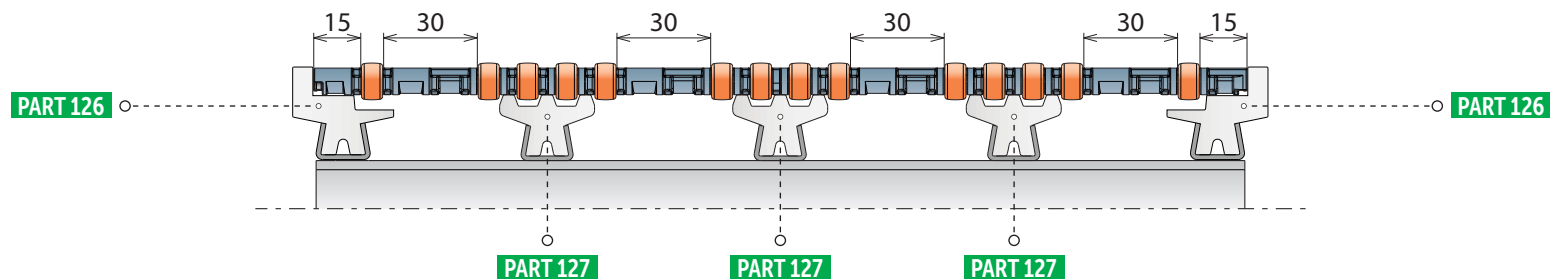

Guide position for driven rollers, for alignment/distribution system - Example

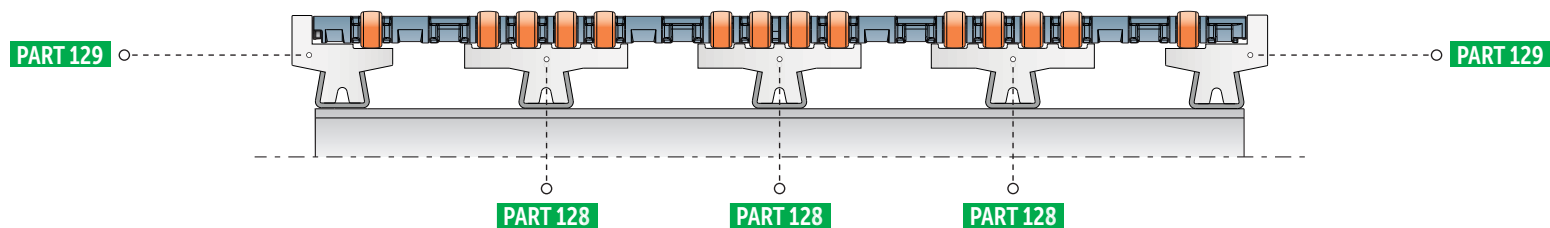

Part	Article-Nr.	Thickness	Metal profile	Colour	Type
126	12601C	1.5	AISI 304	white	

Part	Article-Nr.	Thickness	Metal profile	Colour	Type
128	12801C	1.5	AISI 304	white	

Part	Article-Nr.	Thickness	Metal profile	Colour	Type
127	12701C	1.5	AISI 304	white	

Part	Article-Nr.	Thickness	Metal profile	Colour	Type
129	12901C	1.5	AISI 304	white	



GENERAL RULES

For accumulation system, please place the wear strips between the rollers (max 25 mm).

For driven rollers, please place the wear strips directly in contact under the rollers.

530 PRO LBP can also be used with standard profiles: consult our general catalog for more details.

530 LBP

Transfer Plates

STANDARD

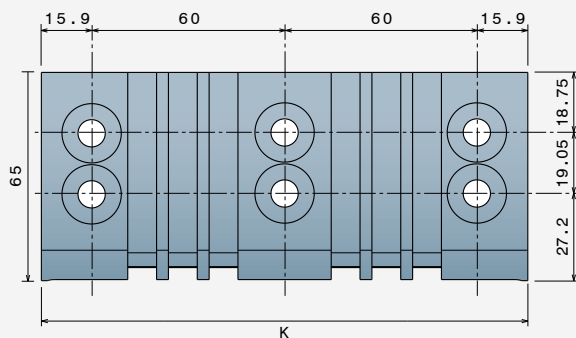

Part	Article Nr.	K
228	22867	152,4

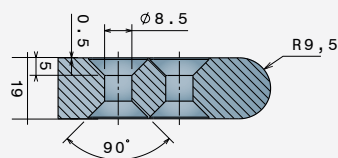

BluLub®

WITH BEARINGS

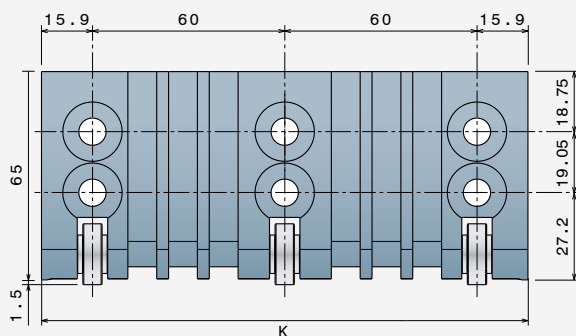

Part	Article Nr.	K
228	22868	152,4

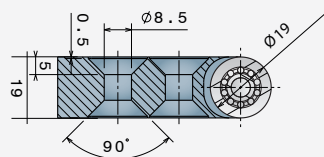

BluLub®



Movex 530 LBP Transfer Plates (standard and with bearings) can be installed in two different ways: **idler side** and **active side**, depending if you want to obtain the accumulation or acceleration effects of the goods. In both versions, the transfer plate is the same: it simply needs to be installed on one side rather than the other.

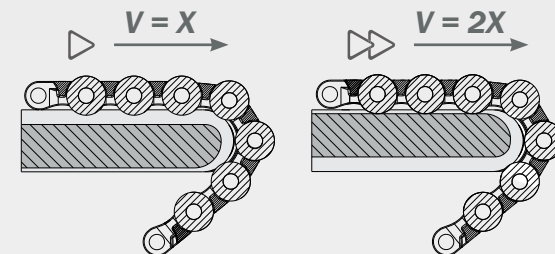
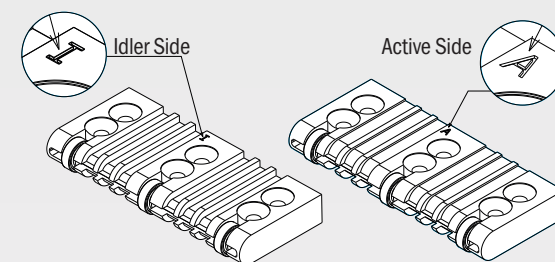

Idler System sectional view

The nosebar, mounted in Idler mode, allows the belts rollers to remain raised above the surface, free to roll.

Active System sectional view

The nosebar, mounted in Active mode, allows the belt rollers to touch the surface, increasing the speed of the goods.

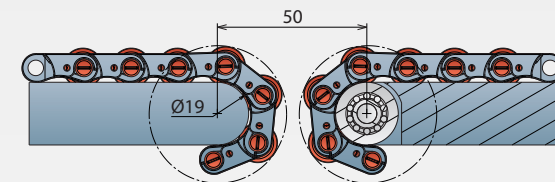

Standard transfer plate

Transfer plate with bearings (recommended)

i Movex® 530 LBP can also be used for a smooth, live transfer without installing a dead plate.

530 PRO LBP Transfer Plates

STANDARD

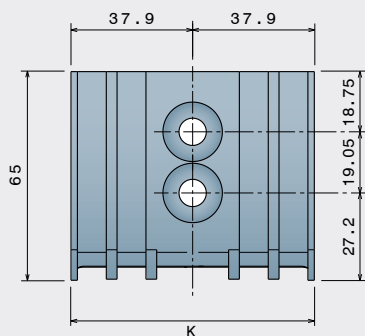

Part	Article Nr.	K
228	22865	76
228	22866	152,4

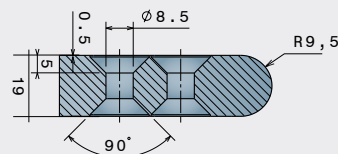
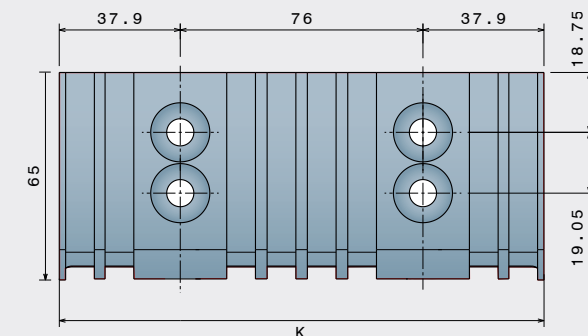

BluLub®

WITH BEARINGS

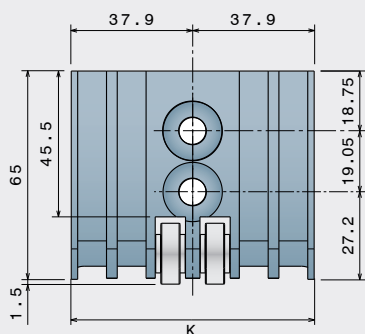

Part	Article Nr.	K
228	22863	76
228	22864	152,4

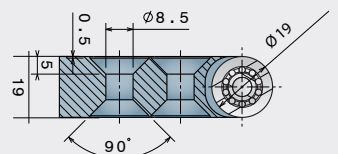
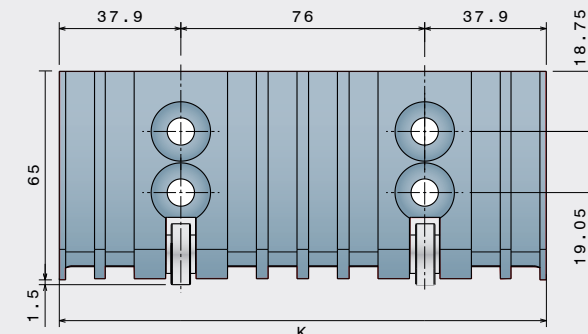

BluLub®

 PATENTED

Movex 530 PRO LBP Transfer Plates (standard and with bearings) can be installed in two different ways: **idler side** and **active side**, depending if you want to obtain the accumulation or acceleration effects of the goods. In both versions, the transfer plate is the same: it simply needs to be installed on one side rather than the other.

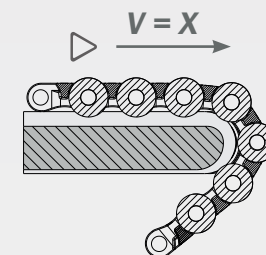
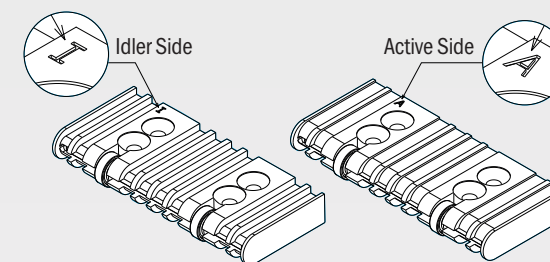

Idler System sectional view

The nosebar, mounted in Idler mode, allows the belt rollers to remain raised above the surface, free to roll.

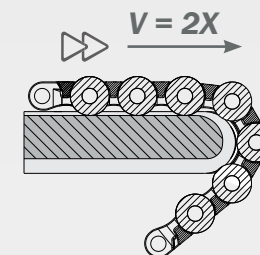

Active System sectional view

The nosebar, mounted in Active mode, allows the belt rollers to touch the surface, increasing the speed of the goods.

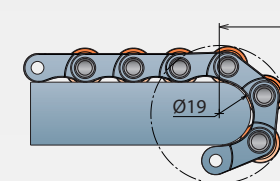

Standard transfer plate

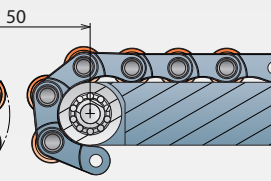

Transfer plate with bearings (recommended)

 Movex® 530 PRO LBP can also be used for a smooth, live transfer without installing a dead plate.

Sprockets

Split drive sprocket, machined

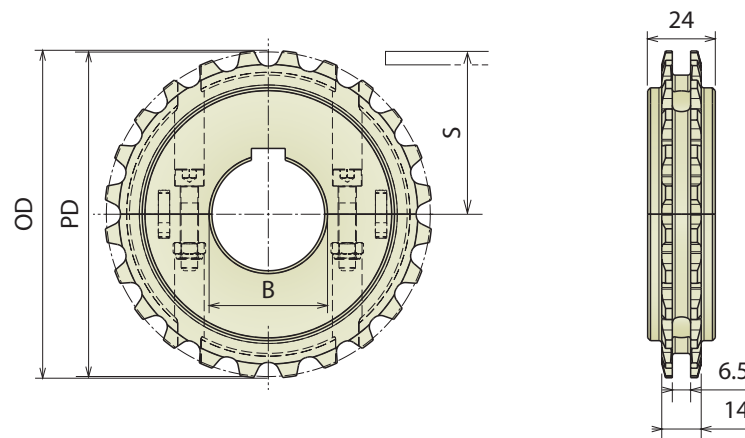

Split idler sprocket, machined

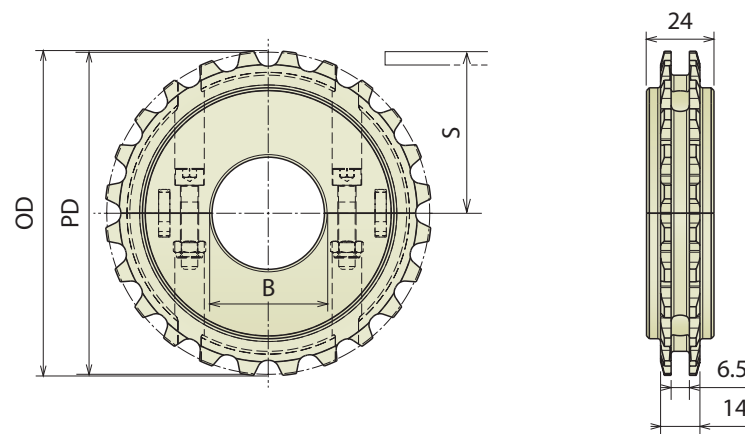

Part	Article-Nr.	Z-	Bore	PD	OD	S
1581	158101E	12**	25	58,1	58,2	24,1
1581	158106E		25x25 ▢			
1582	158201E	16**	25	77,1	77,7	33,6
1582	158202E		30			
1582	158206E		25x25 ▢			
1582	158207E		30x30 ▢			
1583	158301	24	25	114,9	115,5	52,5
1583	158302		30			
1583	158303		35			
1583	158304		40			
1583	158306		25x25 ▢			
1583	158307		30x30 ▢			
1583	158308		40x40 ▢			
1584	158401	32	25	153,4	154,8	71,75
1584	158402		30			
1584	158403		35			
1584	158404		40			
1584	158406		25x25 ▢			
1584	158407		30x30 ▢			
1584	158408		40x40 ▢			

** Idler sprocket Z-12 and Z-16 are supplied non-split.

Part	Article-Nr.	Z-	Bore	PD	OD	S
1581	158150E	12**	18*	58,1	58,2	24,1
1581	158151E		25			
1582	158250E	16**	18*	77,1	77,7	33,6
1582	158251E		25			
1582	158252E		30			
1583	158350	24	18*	114,9	115,5	52,5
1583	158351		25			
1583	158352		30			
1583	158353		35			
1583	158354		40			
1584	158450	32	18*	153,4	154,8	71,75
1584	158451		25			
1584	158452		30			
1584	158453		35			
1584	158454		40			

** Idler sprocket Z-12 and Z-16 are supplied non-split.

* Plain Bore

Sprockets position - Assembling / Disassembling

Position for 530 LBP

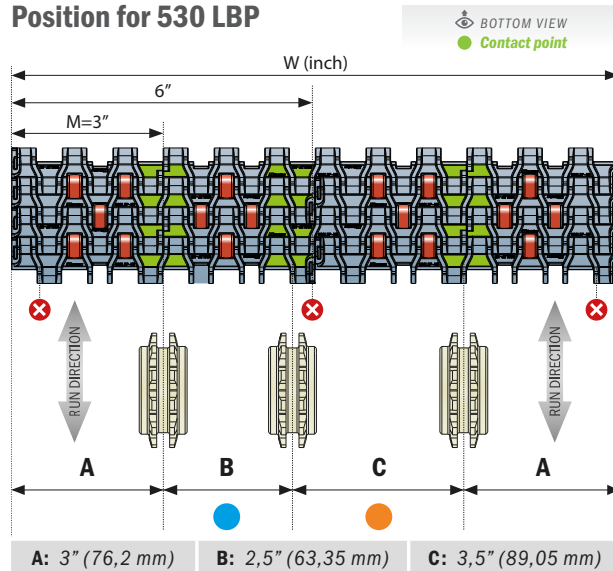

● Add sprocket positions every 152,4 mm according to 152,4 mm width increments of the belt corresponding with 152,4 mm conveyor track pitch system.

Belt width (in/mm)	Number of sprockets *
6 / 152.4	1
12 / 304.5	3
18 / 457.2	5
24 / 609.6	7
30 / 762.0	9
36 / 914.4	11
42 / 1066.8	13
48 / 1219.2	15
54 / 1371.6	17



* If more sprockets are required, contact application engineering.

Position for 530 PRO LBP

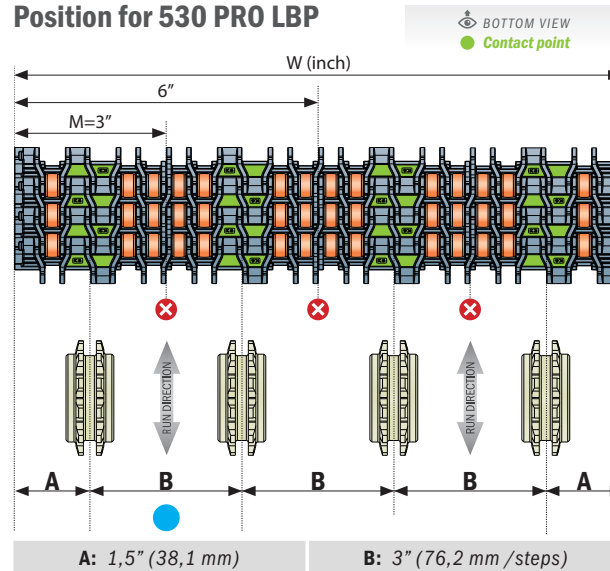

● Add sprocket positions every 76,2 mm according to 176,2 mm width increments of the belt corresponding with 76,2 mm conveyor track pitch system.

Belt width (in/mm)	Number of sprockets *
6 / 152.4	2
9 / 228.6	3
12 / 304.5	4
15 / 381.0	5
18 / 457.2	6
21 / 533.4	7
24 / 609.6	8
27 / 685.8	9
30 / 762.0	10
33 / 838.2	11
36 / 914.4	12
39 / 990.6	13
42 / 1066.8	14
45 / 1143.0	15
48 / 1219.2	16
51 / 1295.4	17
54 / 1371.6	18



It's **NOT** possible to place the sprockets in this position.

Instructions for disassembling 530 LBP (standard clip system)

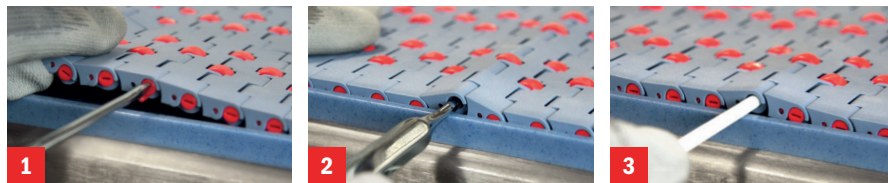

Insert a flat screw driver into the red clip mounted at the sides of the belt, turn it by 90° to leave it from the clip fixation and remove it. Do the same on the opposite side.

Insert a pin punch into the hole left by the extracted red clip and push to extract the white pin.

Once the white pin is removed, the belt can be opened easily pulling the belt.

Instructions for disassembling 530 PRO LBP (Pin Sphere® clip system)



Insert a flat screwdriver with a narrow tip into the hollow below the belt, present at 3mm from the edge. With a slight rotation and applying a firm pressure, push the Pinsphere® outwards. Do the same on the opposite side.

Insert a long pin punch into the hole left by the extracted Pinsphere® and push to extract the white pin.

Once the white pin is removed, the belt can be opened easily pulling the belt.

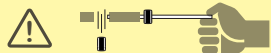

Be careful when dismantling the belt: by removing the **Pin Sphere®** and the white pin, rollers will get out from their seat. Before proceeding to remove the white pin, ensure that the belt ends cannot slip away due to its weight.



Movex around the world

Movex GmbH

P +49-6204-9375-0

Movex Brasil Ltda

P +55-15-3141-2550

Movex France

P +39-335-8085980

Movex AG India

P +91-120-4159660-62

Movex Russia

P +7 (495) 925-88-56

Movex UK Ltd.

P +44-77-20678442

Movex Nederland

P +31-630-994850

Movex USA Inc.

P +1-919-274-5477

Movex SA de CV

P +52-1-331845818

Movex CIS countries

P +380-667507756

Movex S.p.A.**Headquarter**

Viale Industria, 22 - 24060
Castelli Calepio (BG) Italy

Logistics center

Via Repubblica, 25 - 24060
Castelli Calepio (BG) Italy